

KLEM 15W TLU LED Schienenstrahler mit Dimmer am Lampengehäuse

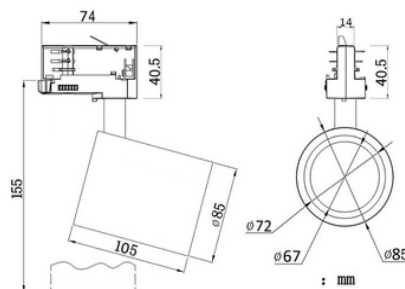

Produkt Beschreibung

LED Schienenstrahler 15W
 Hoher CRI
 3000K/4 000K Ra>90, 5000K Ra>80
 Abstrahlwinkel 15°/24° /36° /60°
 Innenbeleuchtung

Technische Daten

Art.Nr.:	KLEM15WDIM TLU
Watt:	15W
Netzspannung:	220~240V~50/60Hz
Leistungsfaktor:	PF>0.92
Abstrahlwinkel:	15°/24° /36° /60°
Lumen:	5-100% Max 1500lm (±200)
Farbtemperatur:	3000K/4000K/ 5000K
Farbwiedergabeindex:	CRI ≥90
Adapter:	4-Kabel
DimmOptionen:	Dimmer am Lampengehäuse
Gewicht:	0.83kg
Material:	aluminum
Farbe:	weiß oder schwarz
Arbeitstemperatur:	(-20~40 °C)
Aufbewahrungstemperatur:	(-20~80 °C)
Lebensdauer:	50000 Stunden
Zertifikate:	CE, ROHS
Garantie:	5 Jahre
Testberichte:	IES file/ spectrum chart

Verpackung 24 Stc k.16.2kg/KTN 41.5x40.5x31.5 cm V14

*Alle technischen Angaben unterliegen industriellen Messtandards .

CITIZEN
LED Chip Marke

RXPOWER
LED Treiber Marke

Dimmer am Lampengehäuse
Dimm Optionen

Aluminium
Gehäuse

weiß **schwarz**
Farbe

CE **Rohs**

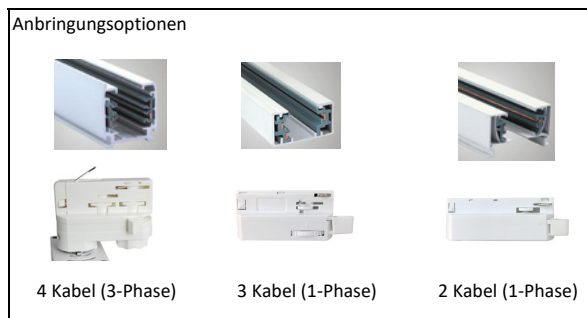

2700K

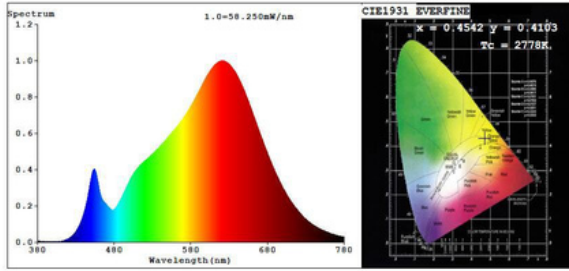

Color Parameters:
 Chromaticity Coordinate: $x=0.4542$ $y=0.4103/u'=0.2590$ $v'=0.5264$
 $T_c=2778K$ (Duv=0.0004) Dominant WL:Ld =583.7nm Purity=59.5%
 Red Ratio:R=27.5% Peak WL:Lp=621.8nm HWL:Lhd=145.6nm
 Render Index:Ra=92.8
 R1 =93 R2 =97 R3 =99 R4 =93 R5 =93 R6 =97 R7 =91
 R8 =80 R9 =56 R10=92 R11=95 R12=85 R13=94 R14=99 R15=88

Photo Parameters:

3000K

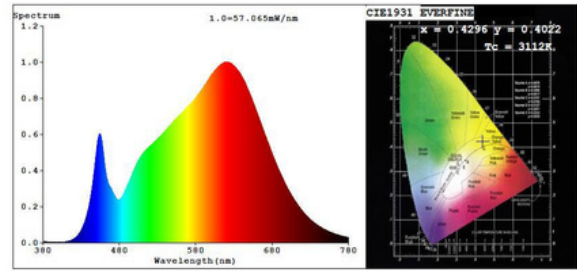

Color Parameters:
 Chromaticity Coordinate: $x=0.4296$ $y=0.4022/u'=0.2466$ $v'=0.5196$
 $T_c=3112K$ (Duv=0.0003) Dominant WL:Ld =582.2nm Purity=49.7%
 Red Ratio:R=25.2% Peak WL:Lp=618.0nm HWL:Lhd=167.4nm
 Render Index:Ra=93.4
 R1 =94 R2 =97 R3 =98 R4 =94 R5 =93 R6 =95 R7 =93
 R8 =84 R9 =62 R10=91 R11=94 R12=80 R13=94 R14=98 R15=90

Photo Parameters:

3500K

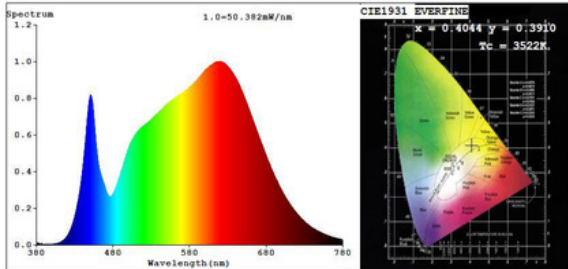

Color Parameters:
 Chromaticity Coordinate: $x=0.4044$ $y=0.3910/u'=0.2350$ $v'=0.5113$
 $T_c=3522K$ (Duv=0.0003) Dominant WL:Ld =580.7nm Purity=38.7%
 Red Ratio:R=23.0% Peak WL:Lp=619.0nm HWL:Lhd=180.8nm
 Render Index:Ra=93.2
 R1 =94 R2 =95 R3 =96 R4 =94 R5 =93 R6 =93 R7 =94
 R8 =86 R9 =65 R10=88 R11=95 R12=79 R13=94 R14=97 R15=91

Photo Parameters:

4000K

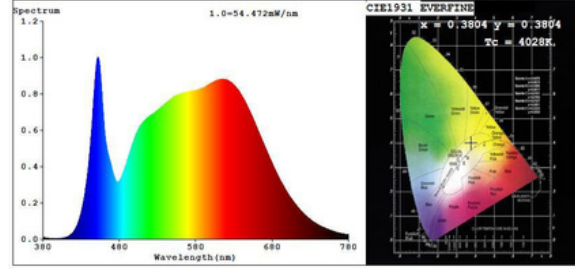

Color Parameters:
 Chromaticity Coordinate: $x=0.3804$ $y=0.3804/u'=0.2236$ $v'=0.5032$
 $T_c=4028K$ (Duv=0.0017) Dominant WL:Ld =578.0nm Purity=28.3%
 Red Ratio:R=20.8% Peak WL:Lp=451.8nm HWL:Lhd=22.1nm
 Render Index:Ra=92.4
 R1 =92 R2 =94 R3 =95 R4 =93 R5 =92 R6 =92 R7 =95
 R8 =86 R9 =64 R10=86 R11=93 R12=72 R13=93 R14=97 R15=90

Photo Parameters:

5000K

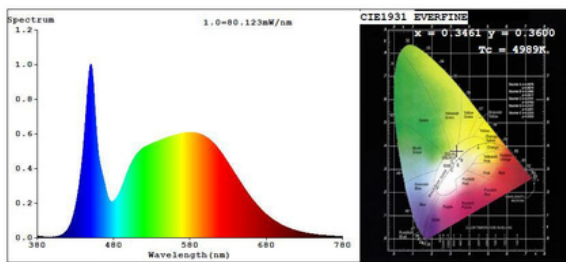

Color Parameters:
 Chromaticity Coordinate: $x=0.3461$ $y=0.3600/u'=0.2089$ $v'=0.4888$
 $T_c=4989K$ (Duv=0.0037) Dominant WL:Ld =569.6nm Purity=11.9%
 Red Ratio:R=16.9% Peak WL:Lp=450.0nm HWL:Lhd=19.8nm
 Render Index:Ra=82.9
 R1 =81 R2 =87 R3 =92 R4 =83 R5 =81 R6 =82 R7 =88
 R8 =69 R9 =10 R10=69 R11=82 R12=58 R13=82 R14=96 R15=75

Photo Parameters:

Original full IES file sent on requested (15°/24°/ 38°/ 60°)

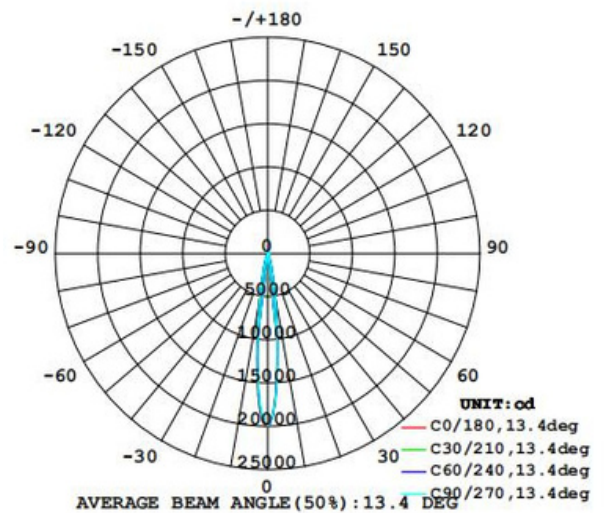

Weitere Details

